



## GENERAL RULES AND INFORMATION

Date: Saturday, May 3, 2025

Time: 11am to 6pm (Vendors may set up as early as 8am)

Place: Campus of St. Mark's Episcopal Church & Community Arts Center  
(driveway will be blocked off to drive-through traffic)

Vendor Fee: None (% of sales is an optional donation)  
Vendors are responsible for collecting and submitting any applicable taxes

Space: Each space will be assigned on a first come, first serve basis  
Spaces will measure approximately 12'x12'. Vendors are required to set up and operate within their set boundaries

Set up: Vendors are responsible for their own tents, tables and chairs. Tents should be weighted. No stakes allowed in asphalt areas. Vendors are responsible for keeping their area clean of debris and trash.

Who can apply: Individual artists and craftsmen (limited number accepted)  
Performing artists and groups (limited number accepted)  
Limited number of food trucks (no beverages, alcohol or sandwiches may be sold. Food vendors will be limited. FoodSafe Certification required)  
Businesses who cater to families (must provide some sort of game or interactive display. Peacock Island businesses will be given 1st preference)

*St. Mark's Episcopal church and Community Arts Center is not responsible for any theft or damage to any vendor booth and goods. By signing below, vendor agrees to abide by all rules and guidelines. Applications must be approved by the ARTSFEST Committee.*

I have read and understand the general rules and guidelines, and agree to abide by them:

Print Name: \_\_\_\_\_ Date: \_\_\_\_\_

Signature: \_\_\_\_\_

**APPLICATION - PLEASE PRINT**

\_\_\_\_ Arts/Crafts Vendor    \_\_\_\_ Food Vendor    \_\_\_\_ Performer    \_\_\_\_ Art Exhibitor

Name: \_\_\_\_\_

Business Name (if applicable) \_\_\_\_\_

Mailing Address: \_\_\_\_\_

Business Address: (if applicable) \_\_\_\_\_

Best phone #: \_\_\_\_\_ Email: \_\_\_\_\_

Website (if applicable) \_\_\_\_\_

Facebook page (if applicable) \_\_\_\_\_

Other social media: \_\_\_\_\_

Describe your product(s) or performance: (photos are helpful)

\_\_\_\_\_  
\_\_\_\_\_  
\_\_\_\_\_

**Performers only:**

We will provide a PA, microphones and sound system. Any special requirements must be discussed with our sound engineer prior to performance. Instruments are preferred, but pre-recorded music is acceptable.

Any special performance requirements: \_\_\_\_\_

\_\_\_\_\_

Email completed application: [cac@stmarksgulfport.com](mailto:cac@stmarksgulfport.com)

Or mail to: Peacock Island Community ArtsFest

11322 W Taylor Rd.

Gulfport, MS 39503

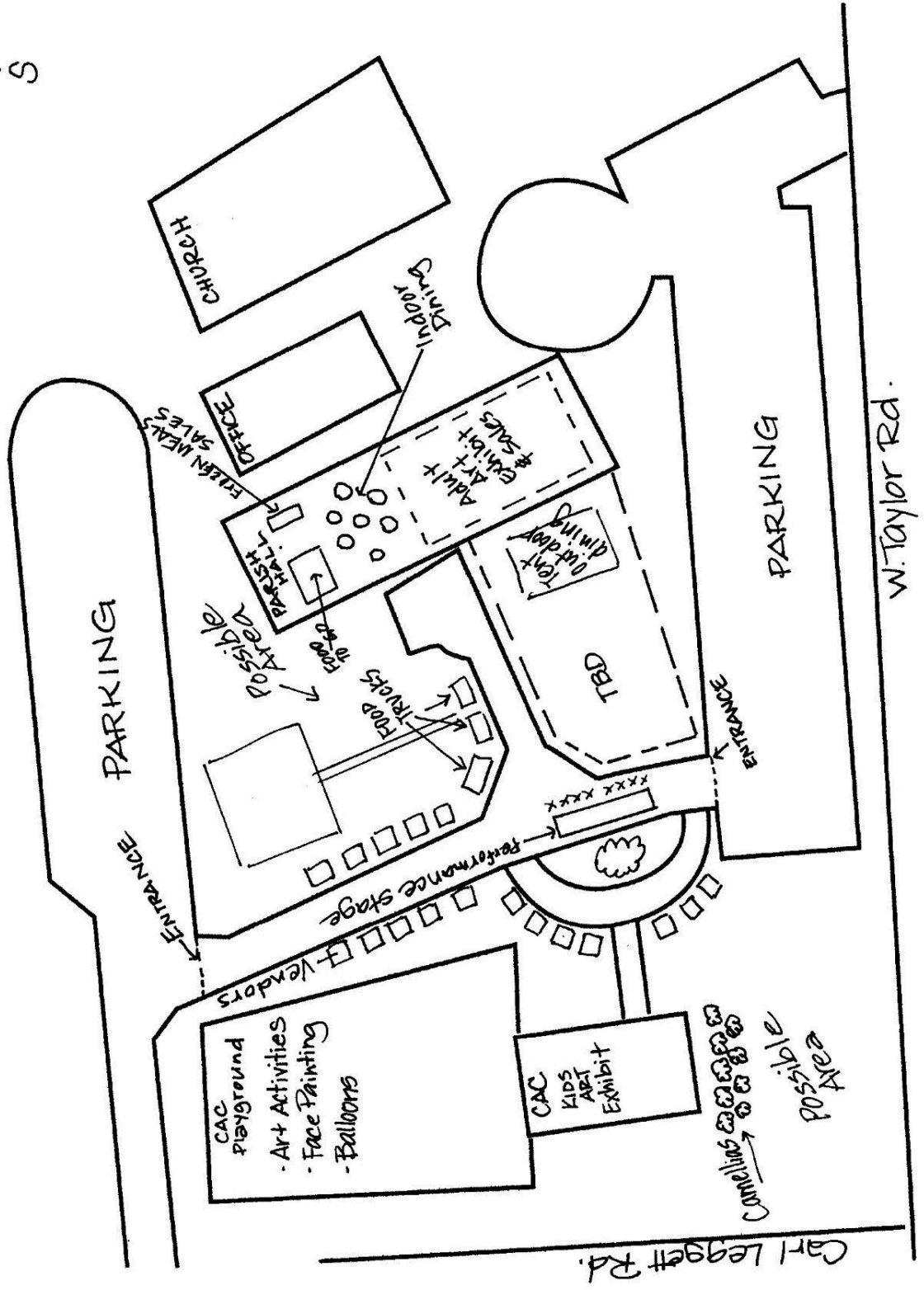
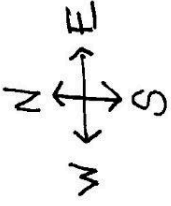

Carl Leggett Rd.

W. Taylor Rd.